

Pre-entries close October 15, 2017 at 2:00 PM CT.
Gate Entries will be accepted day of test for ALL classes
Including Masters.

DALLAS-FORT WORTH DACHSHUND CLUB INC.

AKC EARTHDOG TESTS

LICENSED BY THE AMERICAN KENNEL CLUB

Three Tests in One Weekend

Saturday, October 21, a.m. (2017074412)

Saturday, October 21, p.m. (2017074413)

Sunday, October 22, a.m. (2017074414)



Prospering Farm,
101 Equestrian Way, Prosper, TX

Test Secretary: Nancy Barclay, 2001 Holley Pkwy #611, Roanoke, TX 76262

nancybarclay15@gmail.com



**AMERICAN
KENNEL CLUB™**

CERTIFICATION

Permission has been granted by The American Kennel Club for holding this event under American Kennel Club Rules and Regulations.

Gina DiNardo, Secretary

DALLAS - FORT WORTH DACHSHUND CLUB INC. OFFICERS 2017

President: Ken Hagmueller -
2160 Bells Chapel Rd, Waxahachie, TX, 75165-6753

Vice President: Karen Mann -
5039 CR #168, McKinney, TX 75071

Corresponding Secretary: Tracy Freeling -
5137 Shell Creek Dr., Fort Worth, TX 76137 [taf76137@yahoo.com]

Recording Secretary: Karen Henry -
2415 Bennington Dr., Arlington, TX 76015

Treasurer: Cindi Todd -
6861 Greenleaf, N. Richland Hills, TX 76180

Board of Directors: Kathleen Fulenwider, Lexa Richmond, Larry Innis

TEST COMMITTEE

Chairman: Cindi Todd: 6861 Green Leaf Drive; North Richland Hills, TX
76182 Ph: 817-485-1075 e-mail : laCIMW@sbcglobal.net

SECRETARY: Nancy Barclay, 2001 Holley Pkwy #611, Roanoke, TX 76262

Committee Members:

Cindi Todd, Pam Donze, Nancy Barclay, Karen Mann, Karen Henry, Sandi
Myers, Ken Hagmueller

JUDGES

DeBarrios-Kari, Patricia (98137)	1550 Bridle Bit Road Flower Mound, TX 75922
Baldwin, Cris (90029)	740 Californian Trail Keller, TX 76248
Ellis, Elizabeth (98133)	4308 CR #126 Bedias, TX 77831
Dawn Renee Watters (103083)	P.O. Box 150605 Lakewood, CO 80215
Mann, Karen (97777)	5039 CR #168 McKinney, TX 75071
Dunn, Charlene (46316)	8425 Whistling Duck Fort Worth, TX 76118

EXHIBITORS, PLEASE READ

Prospering Farm is a working Hunter Jumper Equestrian Training Facility. As such there will be normal activity involving horses, riders and grooms in and around the barns and arenas. **For the safety of all the speed limit is 10 mph while on the property. 10 mph is the limit, not a suggestion!**

Exhibitors are also responsible for their children. Unaccompanied children are not allowed in or near barns, arenas, turnouts or pastures anywhere on the property.

Exhibitors and their dogs are not allowed on any agility equipment on the property.

The test is being held at the back of the property away from the barns, turnouts and arenas. Follow the signs to the Earthdog Test location.

There is no club house on this property. A port-a-potty will be provided. There is plenty of room for parking and EZ-Ups. Please park only in designated areas.

Lunch will **not** be served either day. Bring your own snacks, treats and water for your dogs. There are several fast food restaurants in the area close to the test site on Preston Rd north of E. First St. or on Hi-Way 380 east of La Cima Blvd. **Lunch break is at the judge's discretion.**

!!!PLEASE PICK UP AFTER YOUR DOGS!!!

SHOW REGULATIONS

THE FOLLOWING BREEDS ARE CLASSIFIED AS ELIGIBLE TO PARTICIPATE IN AKC EARTHDOG TESTS: Dachshunds and the following Terrier Breeds: Australian, Bedlington, Border, Cairn, Cesky, Dandie Dinmont, Fox (Smooth & Wire), Glen of Imaal, Jagdterrier, Lakeland, Manchester, Miniature Bull, Miniature Pinschers, Miniature Schnauzers, Norfolk, Norwich, Parson Russell, Rat, Russell, Scottish, Sealyham, Silky, Skye, Welsh, West Highland White, & Yorkshire.

ELIGIBILITY: Dogs must be at least 6 months old. Dogs that are spayed or neutered or have a Limited Registration or Purebred Alternative Listing (ILP or PAL) number may participate. A dog of an eligible breed with an acceptable foreign registration number is eligible to participate.

MULTIPLE ENTRIES: Dogs may enter more than one regular class at an earthdog test provided the dog is eligible for the class as defined in AKC regulations for Earthdog Tests, chapter 3.

All exhibitors should obtain a copy of Regulations for Earthdog Tests for Small Terriers and Dachshunds available from AKC via mail at 5580 Centerview Drive Raleigh, NC 27606

Or online at <http://www.akc.org/pdfs/rulebooks/REEDOG.pdf>

JUDGING ASSIGNMENTS

DATE	Intro	Junior	Senior	Master
10/21 A.M.	Cris Baldwn	Patricia Debarrios-Kari	Charlene Dunn	Dawn-Renee Watters
10/21 P.M.	Charlene Dunn	Cris Baldwin	Dawn-Renee Watters	Karen Mann
10/22	Patricia Debarrios-Kari	Elizabeth Ellis	Cris Baldwin	Dawn-Renee Watters

JUDGING SCHEDULE <i>ENTRANTS PLEASE CHECK IN WITH TEST SECRETARY PRIOR TO START OF EACH CLASS</i>				
CLASS	ENTRIES CLOSE Sat A.M. Sunday	CLASS BEGINS No sooner than	ENTRIES CLOSE Sat P.M. (see note 1)	CLASS BEGINS (see note 2)
INTRODUCTION TO QUARRY	8:15 a.m.	8:30 a.m.	see below	see below
MASTER EARTHDOG	8:15 a.m.	8:30 a.m.	see below	see below
SENIOR EARTHDOG	8:45 a.m.	9:00 a.m.	see below	see below
JUNIOR EARTHDOG	5 min. after completion of Intro	10 min. after closing	5 min. after completion of intro	10 min. after closing

*In order to make the most efficient use of time, the closing and starting times of the **after-noon classes will be tied to the end of the morning classes as follows:***

#1. Entries for the afternoon classes will begin to close 30 minutes after the completion of the last class of the morning. Closing time for each class will follow the same pattern and order as the morning classes.

#2. All classes will begin no sooner than 15 minutes following the closing time for each



Tests are run rain or shine so please plan accordingly!

TESTS OFFERED:

Introduction to Quarry (Intro) - Non-regular class. Open to all dogs 6 months or older.

Junior Earthdog - Open to all eligible breeds of dogs. Dogs that have earned a Junior Earthdog title may continue to enter but may not receive another certificate.

Senior Earthdog - Open to dogs that have acquired the Junior Earthdog title and to dogs that have been recorded by the AKC as Senior Earthdogs and/or Master Earthdogs.

Master Earthdog - Open to dogs that have earned a Senior Earthdog title.

RIBBON PRIZES

QUALIFYING SCORE IN A REGULAR CLASS - - - - DARK GREEN RIBBON

QUALIFYING SCORE IN NON-REGULAR CLASS - - - LIGHT GREEN RIBBON

ENTRY FEES:

Intro, pre-entry:	\$12.00	Day of trial:	\$18.00
Junior & Senior, pre-entry:	\$15.00	Day of trial:	\$20.00
Masters, pre-entry:	\$20.00	Day of Trial	\$25.00

Only complete entry forms including Registration/ILP/PAL numbers will be accepted. Please complete a separate entry form for each dog and each class entered.

Send Entries And Fees To:

Nancy Barclay
2001 Holley Pkwy #611
Roanoke, TX 76262

Make checks payable to **DFWDC**

Note: For FedEx or Express Mail entries

SIGNATURE REQUIREMENT MUST BE WAIVED

VETERINARIAN ON CALL

Emergency Animal Hospital of Collin County
10225 Custer Rd Plano, TX 75025 (214)547-9900

****ONE ENTRY FORM, PER CLASS, PER DOG, PER DAY****

OFFICIAL AMERICAN KENNEL CLUB EARTHDOG ENTRY FORM
SATURDAY MORNING

Club **Dallas-Fort Worth Dachshund Club** Date(s) **10/21/2017/A.M.** Event # **2017074412**

Location Enter in Stakes/Test—Select **One** Per Form

Prospering Farm, Prosper, TX Intro Junior Senior Master

Breed

I enclose entry fees
in the amount of

Foreign, List country

Registration/ILP/PAL #

AKC No.

AKC Litter No.

ILP No.

Full Name of Dog

Call Name

Sex

Date of Birth

Sire

Dam

Name of Breeder

Actual Owner(s)

Owner's Address

City

E-Mail Address

Name of Owner's Agent/Handler (if any)

AKC Rules, Regulations, Policies and Guidelines are available on the American Kennel Club website: www.akc.org

AGREEMENT

I CERTIFY THAT I AM THE ACTUAL OWNER OF THE DOG, OR THAT I AM THE DULY AUTHORIZED AGENT OF THE ACTUAL OWNER WHOSE NAME I HAVE ENTERED ABOVE. IN CONSIDERATION OF THE ACCEPTANCE OF THIS ENTRY, I (WE) AGREE TO ABIDE BY THE RULES AND REGULATIONS OF THE AMERICAN KENNEL CLUB IN EFFECT AT THE TIME OF THIS EVENT AND ANY ADDITIONAL RULES AND REGULATIONS APPEARING IN THE PREMIUM LIST OF THIS EVENT AND ENTRY FORM AND ANY DECISION MADE IN ACCORD WITH THEM. I (WE) AGREE THAT THE CLUB HOLDING THIS EVENT HAS THE RIGHT TO REFUSE THIS ENTRY FOR CAUSE WHICH THE CLUB SHALL DEEM SUFFICIENT. IN CONSIDERATION OF THE ACCEPTANCE OF THIS ENTRY AND OF THE HOLDING OF THIS EVENT AND OF THE OPPORTUNITY TO HAVE THE DOG JUDGE AND TO WIN PRIZES, RIBBONS, OR TROPHIES, I (WE) AGREE TO HOLD THE AKC, THE EVENT-GIVING CLUB, THEIR MEMBERS, DIRECTORS, GOVERNORS, OFFICERS, AGENTS, SUPERINTENDENTS OR EVENT SECRETARY AND THE OWNER AND/OR LESSOR OF THE PREMISES AND ANY PROVIDER OF SERVICES THAT ARE NECESSARY TO HOLD THIS EVENT AND ANY EMPLOYEES OR VOLUNTEERS OF THE AFOREMENTIONED PARTIES, AND ANY AKC APPROVED JUDGE, JUDGING AT THIS EVENT, HARMLESS FROM ANY CLAIM FOR LOSS OR INJURY WHICH MAY BE ALLEGED TO HAVE BEEN CAUSED DIRECTLY OR INDIRECTLY TO ANY PERSON OR THING BY THE ACT OF THIS DOG WHILE IN OR ABOUT THE EVENT PREMISES OR GROUNDS OR NEAR ANY ENTRANCE THERETO, AND I (WE) PERSONALLY ASSUME ALL RESPONSIBILITY AND LIABILITY FOR ANY SUCH CLAIM,; AND I (WE) FURTHER AGREE TO HOLD THE AFOREMENTIONED PARTIES HARMLESS FROM ANY CLAIM FOR LOSS, INJURY OR DAMAGE TO THIS DOG. ADDITIONALLY, I (WE) HEREBY ASSUME THE SOLE RESPONSIBILITY FOR AND AGREE TO INDEMNIFY, DEFEND AND SAVE THE AFOREMENTIONED PARTIES HARMLESS FROM ANY AND ALL LOSS AND EXPENSE (INCLUDING LEGAL FEES) BY REASON OF THE LIABILITY IMPOSED BY LAW UPON ANY OF THE AFOREMENTIONED PARTIES FOR DAMAGE BECAUSE OF BODILY INJURIES, INCLUDING DEATH AT ANY TIME RESULTING THEREFROM, SUSTAINED BY ANY PERSON OR PERSONS, INCLUDING MYSELF (OURSELVES), OR ON ACCOUNT OF DAMAGE TO PROPERTY, ARISING OUT OF OR IN CONSEQUENCE OF MY (OUR) PARTICIPATION IN THIS EVENT, HOWEVER SUCH, INJURIES, DEATH OR PROPERTY DAMAGE MAY BE CAUSED, AND WHETHER OR NOT THE SAME MAY HAVE BEEN CAUSED OR MAY BE ALLEGED TO HAVE BEEN CAUSED BY THE NEGLIGENCE OF THE AFOREMENTIONED PARTIES OR ANY OF THEIR EMPLOYEES, AGENTS, OR ANY OTHER PERSONS. I (WE) AGREE THAT ANY CAUSE OF ACTION, CONTROVERSY OR CLAIM ARISING OUT OF OR RELATED TO THE ENTRY, EXHIBITION OR ATTENDANCE AT THE EVENT BETWEEN THE AKC AND THE EVENT-GIVING CLUB (UNLESS OTHERWISE STATED IN THIS PREMIUM LIST) AND MYSELF (OURSELVES) OR AS TO THE CONSTRUCTION, INTERPRETATION AND EFFECT OF THIS AGREEMENT SHALL BE SETTLED BY ARBITRATION PUSUANT TO THE APPLICABLE RULES OF THE AMERICAN ARBITRATION ASSOCIATION. HOWEVER, PRIOR TO ARBITRATION ALL APPLICABLE AKC BYLAWS, RULES, REGULATIONS AND PROCEDURES MUST FIRST BE FOLLOWED AS SET FORTH IN THE AKC CHARTER AND BYLAWS, RULES, REGULATIONS PUBLISHED POLICIES AND GUIDELINES.

SIGNATURE OF OWNER OR HIS AGENT DULY AUTHORIZED TO MAKE THIS ENTRY

*****ONE ENTRY FORM, PER CLASS, PER DOG, PER DAY*****

OFFICIAL AMERICAN KENNEL CLUB EARTHDOG ENTRY FORM
SATURDAY AFTERNOON

Club **Dallas-Fort Worth Dachshund Club** Date(s) **10/21/2017/P.M.** Event # **2017074413**

Location **Prospering Farm, Prosper, TX** Enter in Stakes/Test—Select **One** Per Form

Intro Junior Senior Master

Breed _____ I enclose entry fees in the amount of _____

Foreign, List country _____

Registration/ILP/PAL # _____

AKC No. _____ AKC Litter No. _____ ILP No. _____

Full Name of Dog _____

Call Name _____

Sex _____

Date of Birth _____

Sire _____

Dam _____

Name of Breeder _____

Actual Owner(s) _____

Owner's Address _____

City _____

E-Mail Address _____

Name of Owner's Agent/Handler (if any) _____

AKC Rules, Regulations, Policies and Guidelines are available on the American Kennel Club website: www.akc.org

AGREEMENT

I CERTIFY THAT I AM THE ACTUAL OWNER OF THE DOG, OR THAT I AM THE DULY AUTHORIZED AGENT OF THE ACTUAL OWNER WHOSE NAME I HAVE ENTERED ABOVE. IN CONSIDERATION OF THE ACCEPTANCE OF THIS ENTRY, I (WE) AGREE TO ABIDE BY THE RULES AND REGULATIONS OF THE AMERICAN KENNEL CLUB IN EFFECT AT THE TIME OF THIS EVENT AND ANY ADDITIONAL RULES AND REGULATIONS APPEARING IN THE PREMIUM LIST OF THIS EVENT AND ENTRY FORM AND ANY DECISION MADE IN ACCORD WITH THEM. I (WE) AGREE THAT THE CLUB HOLDING THIS EVENT HAS THE RIGHT TO REFUSE THIS ENTRY FOR CAUSE WHICH THE CLUB SHALL DEEM SUFFICIENT. IN CONSIDERATION OF THE ACCEPTANCE OF THIS ENTRY AND OF THE HOLDING OF THIS EVENT AND OF THE OPPORTUNITY TO HAVE THE DOG JUDGE AND TO WIN PRIZES, RIBBONS, OR TROPHIES, I (WE) AGREE TO HOLD THE AKC, THE EVENT-GIVING CLUB, THEIR MEMBERS, DIRECTORS, GOVERNORS, OFFICERS, AGENTS, SUPERINTENDENTS OR EVENT SECRETARY AND THE OWNER AND/OR LESSOR OF THE PREMISES AND ANY PROVIDER OF SERVICES THAT ARE NECESSARY TO HOLD THIS EVENT AND ANY EMPLOYEES OR VOLUNTEERS OF THE AFOREMENTIONED PARTIES, AND ANY AKC APPROVED JUDGE, JUDGING AT THIS EVENT, HARMLESS FROM ANY CLAIM FOR LOSS OR INJURY WHICH MAY BE ALLEGED TO HAVE BEEN CAUSED DIRECTLY OR INDIRECTLY TO ANY PERSON OR THING BY THE ACT OF THIS DOG WHILE IN OR ABOUT THE EVENT PREMISES OR GROUNDS OR NEAR ANY ENTRANCE THERETO, AND I (WE) PERSONALLY ASSUME ALL RESPONSIBILITY AND LIABILITY FOR ANY SUCH CLAIM.; AND I (WE) FURTHER AGREE TO HOLD THE AFOREMENTIONED PARTIES HARMLESS FROM ANY CLAIM FOR LOSS, INJURY OR DAMAGE TO THIS DOG. ADDITIONALLY, I (WE) HEREBY ASSUME THE SOLE RESPONSIBILITY FOR AND AGREE TO INDEMNIFY, DEFEND AND SAVE THE AFOREMENTIONED PARTIES HARMLESS FROM ANY AND ALL LOSS AND EXPENSE (INCLUDING LEGAL FEES) BY REASON OF THE LIABILITY IMPOSED BY LAW UPON ANY OF THE AFOREMENTIONED PARTIES FOR DAMAGE BECAUSE OF BODILY INJURIES, INCLUDING DEATH AT ANY TIME RESULTING THEREFROM, SUSTAINED BY ANY PERSON OR PERSONS, INCLUDING MYSELF (OURSELVES), OR ON ACCOUNT OF DAMAGE TO PROPERTY, ARISING OUT OF OR IN CONSEQUENCE OF MY (OUR) PARTICIPATION IN THIS EVENT, HOWEVER SUCH, INJURIES, DEATH OR PROPERTY DAMAGE MAY BE CAUSED, AND WHETHER OR NOT THE SAME MAY HAVE BEEN CAUSED OR MAY BE ALLEGED TO HAVE BEEN CAUSED BY THE NEGLIGENCE OF THE AFOREMENTIONED PARTIES OR ANY OF THEIR EMPLOYEES, AGENTS, OR ANY OTHER PERSONS. I (WE) AGREE THAT ANY CAUSE OF ACTION, CONTROVERSY OR CLAIM ARISING OUT OF OR RELATED TO THE ENTRY, EXHIBITION OR ATTENDANCE AT THE EVENT BETWEEN THE AKC AND THE EVENT-GIVING CLUB (UNLESS OTHERWISE STATED IN THIS PREMIUM LIST) AND MYSELF (OURSELVES) OR AS TO THE CONSTRUCTION, INTERPRETATION AND EFFECT OF THIS AGREEMENT SHALL BE SETTLED BY ARBITRATION PUSUANT TO THE APPLICABLE RULES OF THE AMERICAN ARBITRATION ASSOCIATION. HOWEVER, PRIOR TO ARBITRATION ALL APPLICABLE AKC BY-LAWS, RULES, REGULATIONS AND PROCEDURES MUST FIRST BE FOLLOWED AS SET FORTH IN THE AKC CHARTER AND BYLAWS, RULES, REGULATIONS PUBLISHED POLICIES AND GUIDELINES.

SIGNATURE OF OWNER OR HIS AGENT DULY AUTHORIZED TO MAKE THIS ENTRY

THE ENDURANCE EARTHDOG TITLE

In order to be eligible to earn an Endurance Earthdog (EE) title, a dog must have already earned a Master Earthdog title. An Endurance Earthdog title is earned when a dog, on five occasions, passes both the Senior and Master classes at the same event (one event number). The owner shall record each of the five Double Qualifications on a form provided by AKC. Once five Double Qualifications have been awarded, the completed form is submitted to the AKC along with a title recording fee of \$30. Upon verification, a title certificate will be issued to the owner and the dog shall be identified as an Endurance Earthdog by the suffix title EE.

New Endurance Earthdog title requirements and information may be found at http://www.akc.org/pdfs/events/earthdog/letter_EE_title.pdf

EARTHDOG PRACTICE

There will be a practice for
Intro, Junior and Senior Earthdog Class
on Sunday, October 15, 2017.

The practice will be held at the Test Site in Prosper,
Time to be announced. If you would be interested in
receiving an entry form for the Practice, contact:

Cindi Todd lacimw@sbcglobal.net
or: 817-485-1075

(you *must* pre-enter the practice)

Interested in judging Earthdog? Begin by serving as an apprentice at an AKC test.

We follow the AKC Judge's Eligibility Requirements found at http://www.akc.org/events/earthdog/judges_eligibility.cfm To find out more and to arrange an apprenticing assignment at this test, contact Cindi Todd at lacimw@sbcglobal.net.

*******ONE ENTRY FORM, PER CLASS, PER DOG, PER DAY*******
OFFICIAL AMERICAN KENNEL CLUB EARTHDOG ENTRY FORM
SUNDAY MORNING

Club Dallas-Fort Worth Dachshund Club	Date(s) 10/22/2017	Event # 2017074414
---	------------------------------	------------------------------

Location Prospering Farm, Prosper, TX	Enter in Stakes/Test—Select One Per Form <input type="checkbox"/> Intro <input type="checkbox"/> Junior <input type="checkbox"/> Senior <input type="checkbox"/> Master
---	--

Breed	I enclose entry fees in the amount of
-------	---------------------------------------

<input type="checkbox"/>	<input type="checkbox"/>	<input type="checkbox"/>	<input type="checkbox"/>	Foreign, List country	Registration/ILP/PAL #
AKC No.	AKC Litter No.	ILP No.			

Full Name of Dog

Call Name	Sex	Date of Birth
-----------	-----	---------------

Sire

Dam

Name of Breeder

Actual Owner(s)

Owner's Address

City

E-Mail Address

Name of Owner's Agent/Handler (if any)

AKC Rules, Regulations, Policies and Guidelines are available on the American Kennel Club website: www.akc.org

AGREEMENT

I CERTIFY THAT I AM THE ACTUAL OWNER OF THE DOG, OR THAT I AM THE DULY AUTHORIZED AGENT OF THE ACTUAL OWNER WHOSE NAME I HAVE ENTERED ABOVE. IN CONSIDERATION OF THE ACCEPTANCE OF THIS ENTRY, I (WE) AGREE TO ABIDE BY THE RULES AND REGULATIONS OF THE AMERICAN KENNEL CLUB IN EFFECT AT THE TIME OF THIS EVENT AND ANY ADDITIONAL RULES AND REGULATIONS APPEARING IN THE PREMIUM LIST OF THIS EVENT AND ENTRY FORM AND ANY DECISION MADE IN ACCORD WITH THEM. I (WE) AGREE THAT THE CLUB HOLDING THIS EVENT HAS THE RIGHT TO REFUSE THIS ENTRY FOR CAUSE WHICH THE CLUB SHALL DEEM SUFFICIENT. IN CONSIDERATION OF THE ACCEPTANCE OF THIS ENTRY AND OF THE HOLDING OF THIS EVENT AND OF THE OPPORTUNITY TO HAVE THE DOG JUDGE AND TO WIN PRIZES, RIBBONS, OR TROPHIES, I (WE) AGREE TO HOLD THE AKC, THE EVENT-GIVING CLUB, THEIR MEMBERS, DIRECTORS, GOVERNORS, OFFICERS, AGENTS, SUPERINTENDENTS OR EVENT SECRETARY AND THE OWNER AND/OR LESSOR OF THE PREMISES AND ANY PROVIDER OF SERVICES THAT ARE NECESSARY TO HOLD THIS EVENT AND ANY EMPLOYEES OR VOLUNTEERS OF THE AFOREMENTIONED PARTIES, AND ANY AKC APPROVED JUDGE, JUDGING AT THIS EVENT, HARMLESS FROM ANY CLAIM FOR LOSS OR INJURY WHICH MAY BE ALLEGED TO HAVE BEEN CAUSED DIRECTLY OR INDIRECTLY TO ANY PERSON OR THING BY THE ACT OF THIS DOG WHILE IN OR ABOUT THE EVENT PREMISES OR GROUNDS OR NEAR ANY ENTRANCE THERETO, AND I (WE) PERSONALLY ASSUME ALL RESPONSIBILITY AND LIABILITY FOR ANY SUCH CLAIM.; AND I (WE) FURTHER AGREE TO HOLD THE AFOREMENTIONED PARTIES HARMLESS FROM ANY CLAIM FOR LOSS, INJURY OR DAMAGE TO THIS DOG. ADDITIONALLY, I (WE) HEREBY ASSUME THE SOLE RESPONSIBILITY FOR AND AGREE TO INDEMNIFY, DEFEND AND SAVE THE AFOREMENTIONED PARTIES HARMLESS FROM ANY AND ALL LOSS AND EXPENSE (INCLUDING LEGAL FEES) BY REASON OF THE LIABILITY IMPOSED BY LAW UPON ANY OF THE AFOREMENTIONED PARTIES FOR DAMAGE BECAUSE OF BODILY INJURIES, INCLUDING DEATH AT ANY TIME RESULTING THEREFROM, SUSTAINED BY ANY PERSON OR PERSONS, INCLUDING MYSELF (OURSELVES), OR ON ACCOUNT OF DAMAGE TO PROPERTY, ARISING OUT OF OR IN CONSEQUENCE OF MY (OUR) PARTICIPATION IN THIS EVENT, HOWEVER SUCH, INJURIES, DEATH OR PROPERTY DAMAGE MAY BE CAUSED, AND WHETHER OR NOT THE SAME MAY HAVE BEEN CAUSED OR MAY BE ALLEGED TO HAVE BEEN CAUSED BY THE NEGLIGENCE OF THE AFOREMENTIONED PARTIES OR ANY OF THEIR EMPLOYEES, AGENTS, OR ANY OTHER PERSONS. I (WE) AGREE THAT ANY CAUSE OF ACTION, CONTROVERSY OR CLAIM ARISING OUT OF OR RELATED TO THE ENTRY, EXHIBITION OR ATTENDANCE AT THE EVENT BETWEEN THE AKC AND THE EVENT-GIVING CLUB (UNLESS OTHERWISE STATED IN THIS PREMIUM LIST) AND MYSELF (OURSELVES) OR AS TO THE CONSTRUCTION, INTERPRETATION AND EFFECT OF THIS AGREEMENT SHALL BE SETTLED BY ARBITRATION PUSUANT TO THE APPLICABLE RULES OF THE AMERICAN ARBITRATION ASSOCIATION. HOWEVER, PRIOR TO ARBITRATION ALL APPLICABLE AKC BY-LAWS, RULES, REGULATIONS AND PROCEDURES MUST FIRST BE FOLLOWED AS SET FORTH IN THE AKC CHARTER AND BYLAWS, RULES, REGULATIONS PUBLISHED POLICIES AND GUIDELINES.

SIGNATURE OF OWNER OR HIS AGENT DULY AUTHORIZED TO MAKE THIS ENTRY

ATTENTION EXHIBITORS

1. No bitches in season will be allowed to run. Entry fees paid for a bitch that comes into season will not be refunded. Bitches in season shall not be allowed to enter the test and shall not be allowed within 100 feet of any testing area during the running of any class.
2. Entry fees will not be refunded in the event that a dog is absent, disqualified or excused by the Judge or Veterinarian, or barred by the Test Committee. No entry fees will be returned if the Test cannot start or be completed due to an Act of God or any cause beyond control of the Test Committee.
3. The Test Committee may decline any entries or may remove any dog from the event for cause, but in each such instance shall file good and sufficient reasons for doing so with the American Kennel Club.
4. The owner or handler entering a dog in these Tests does so at his or her own risk and agrees to assume responsibility for any damage caused by him/her or by his/her dog. He/she also agrees to abide by all rules set forth in this Premium list.
5. Barking dogs outside the Test Area should be removed from the area but *not* disciplined for barking.
6. **Flex leads will not be allowed at the test site.**
7. No dog will be allowed in the Test Area until his or her judging time.
8. Confirmed entrants not present at the testing area when their number is called will be moved to the end of the class. Master Earthdog entrants will be declared absent if they do not show within 5 minutes of their brace being called.
9. **No Exhibition Only Entries for non eligible dogs will be accepted. See show regulations for eligibility requirements.**

MOTELS & CAMPING

Days Inn of McKinney 2104 N.
Central Expressway (Exit 41)
McKinney, TX 75070-3744
(972) 548-8888

Super 8 Motel - McKinney
910 N. Central Expressway
McKinney, TX 75070-3304
(972) 548-8880

Motel 6 of McKinney
2125 White Avenue (Exit 40-B)
McKinney, TX 75069
(972) 542-8600

Lighthouse RV Resort
1020 N. Central Expressway
McKinney, TX 75070-3306
(972) 838-4600

Quality Inn McKinney
1300 N. Central Expy
McKinney, TX, 75069
866-539-0036

La Quinta Inn & Suites McKinney
6501 Henneman Way
McKinney, TX 75070
972-908-2370

VOLUNTEER FORM

It takes **many hands** to run a successful and efficient Earthdog Test. Please consider volunteering. If you would like to volunteer to help at this test, take into consideration which tests you will be entering. If you are entered in Senior, volunteer to help with Masters. If you are entered in Junior, volunteer to help with Intro etc. You will be instructed as to what is required of each job. Volunteers will receive lunch. (You can also volunteer the day of the Test.)

I would like to volunteer for the following jobs:

___ Rat Steward (Needed For Master & Senior Tests only)

___ Judges Steward (Needed For All Tests)

___ Gate Steward (Needed For All Tests)

___ Leash Steward (Needed For Intro & JE Only)

I will be running dogs in the following tests: (Please indicate the number of dogs)

I have ___ dogs entered in Intro To Quarry

I have ___ dogs entered in Junior EarthDog

I have ___ dogs entered in Senior EarthDog

I have ___ dogs entered in Master EarthDog

I am available to work _____ Saturday _____ Sunday

My Name is _____

My E-Mail Address is _____

**You can cut and paste this information and send via e-mail to
Cindi Todd (lacimw@sbcglobal.net)**

or

**Return this form by mail with your pre-entry by October 15,
2017 To :**

Nancy Barclay, Test Secretary
2001 Holley Pkwy #611, Roanoke, TX 76262
Nancybarclay15@gmail.com



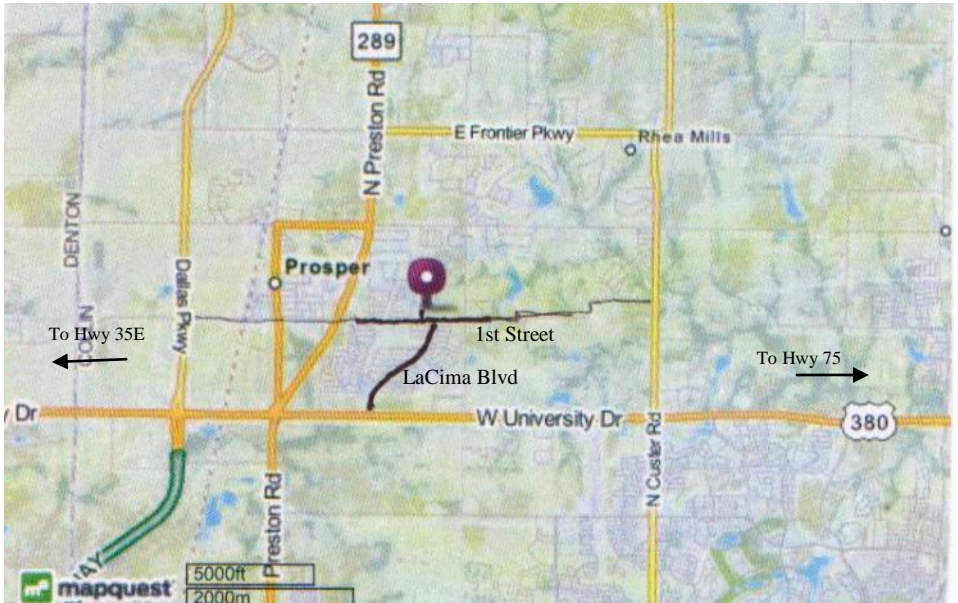

Map to Prospering Farm—101 Equestrian Way

DIRECTIONS: Prospering Farm 101 Equestrian Way, Prosper, TX 75078

From US 75

Take the US 380 Exit (University Drive) west to La Cima Blvd. Go North on La Cima to E. First St. Take a left at the stop sign on E. First St and immediately take a right onto Equestrian Way.
Go slowly (10 mph) and follow signs to Earthdog site.

From North Dallas Toll-way or I-35E

Take US 380 east (University Drive) to La Cima Blvd. Turn left onto La Cima and proceed as above.